

Questions? Please call Help Desk 1-888-748-2627

All this information along with a video guide is available in the Phone APP

WatchPAT One

Patient Step by Step Instructions



itamar medical

1

What is Needed for WatchPAT ONE study?



WatchPAT ONE Phone Internet Access PIN Number

WatchPAT ONE app should be installed from App Store or Google Play



Download on the App Store

Google Play

itamar medical

2

Download App & Accept Access Requests

Like other apps WatchPAT ONE requires access to location and files on smartphone. App can be deleted after study is completed but not before

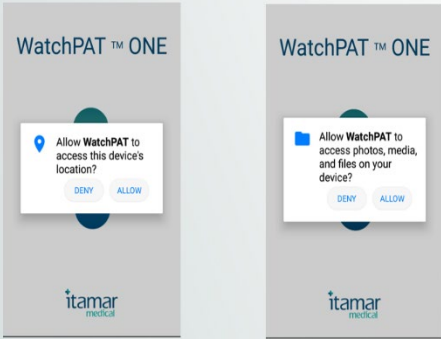

itamar medical

3

Welcome Screen

- Preview button gives opportunity to review entire step by step prior to preparing device & initiating study
- Also video button brings step by step video

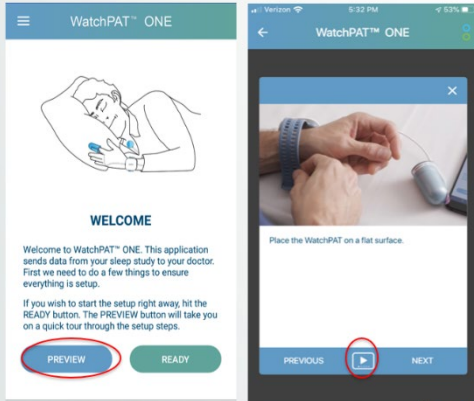

itamar medical

4

Plug In Your Phone Charger & Keep Within 15 feet of Your Bed.

Before inserting battery Connect Phone to Charger & keep connected all night

Keep Phone Within 15 ft or 5m before inserting battery.

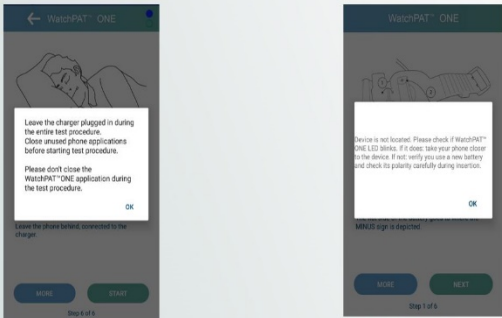

itamar medical

5

Insert AAA Battery

- Patient should insert the battery
- WatchPAT ONE Then Locates Phone via Bluetooth
- Battery provided by the clinic

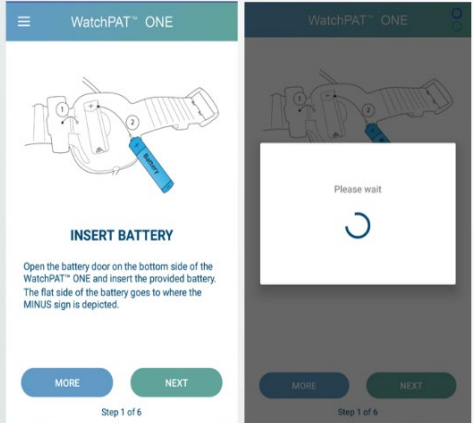

itamar medical

6

Remove Jewelry & Clip Nail on Probe Finger

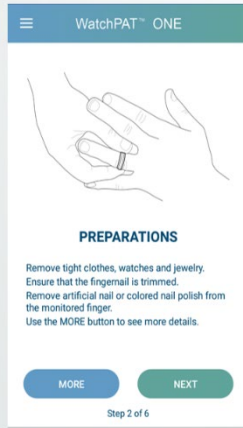

7

Enter 4 Digit Pre-assigned PIN

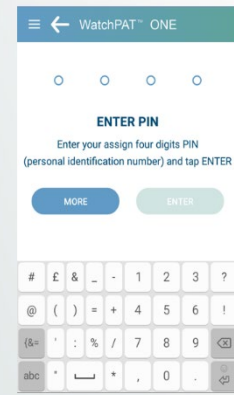

8

Attach - 3 Points of Contact

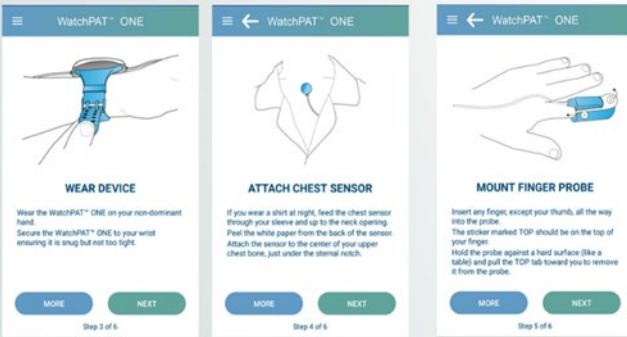

9

Start Recording

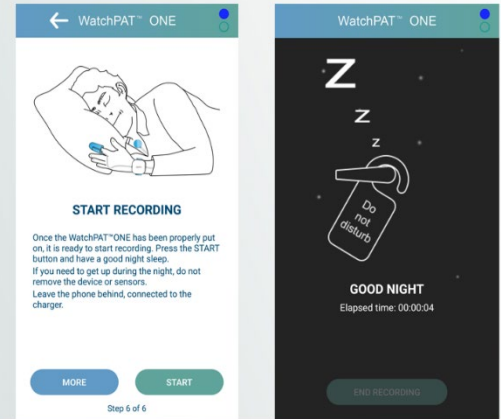

10

In Morning...End Recording...Finish Downloading Data

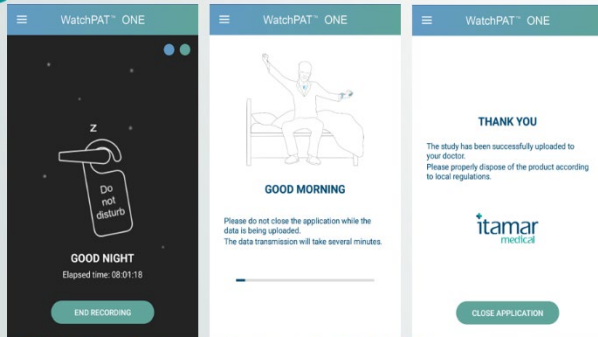

* Failure to end recording will result in delays accessing the data (up to 15h)

11

Step by Step WatchPAT ONE Video Website Information

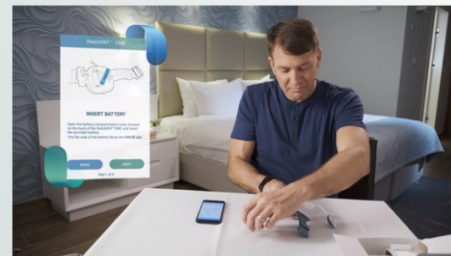

www.watchpatone-howtouse.com

12

Questions? Please call Help Desk 1-888-748-2627

All this information along with a video guide is available in the Phone APP